



**Grinnell**<sup>®</sup>  
MECHANICAL PRODUCTS

## Figure 9097 HDPE Transition Coupling

Ideal for:

- Mining
- Irrigation
- Tunneling

Now available in sizes 2 to 12 inches

The Figure 9097 HDPE Transition Coupling is part of GRINNELL<sup>®</sup> Mechanical Products HDPE System for joining HDPE (high-density polyethylene) pipe. The coupling features a four-bolt coupling design, with gripping teeth on one side, and a grooved end to create a leak-tight joint between HDPE and grooved piping systems.

Additional Features:

- Contoured housing features an integrated ramp design which helps avoid obstacles while relocating pipe runs
- Ensures installation is safer, faster and more cost effective than traditional joining methods
- Backed by the industry's best 10-year limited warranty

For technical details and ordering information, refer to **Technical Data Sheet G582**.



**Figure 9097 HDPE Transition Coupling**

### TECHNICAL DATA

#### Sizes

2" to 12" (DN50 to DN300)

#### Housing

Ductile iron conforming to ASTM A-536, Grade 65-45-12

#### Protective Coatings

Orange paint (standard)

#### Bolt/Nuts

Track Head Bolts – conforming to ASTM A-183, Zinc Plated (Min. Tensile = 110,000 psi/758,422 kPa)

Hexagonal Nuts – conforming to ASTM A-563, Zinc Plated

#### Gasket

-30°F (-34C) to +230°F (+110°C)

A petroleum-free, silicone-based lubricant, such as Dow Corning<sup>®</sup> 7 Release Compound is required for use in HDPE Couplings.

To prevent deterioration of gasket material, hydrocarbons should never be used with EPDM gaskets. See Data Sheet G610 for more gasket information.



800-558-5236  
[www.grinnell.com](http://www.grinnell.com)



**Grinnell**<sup>®</sup>  
MECHANICAL PRODUCTS

by Tyco Fire Suppression & Building Products

# Figure 9097

## HDPE Transition Coupling

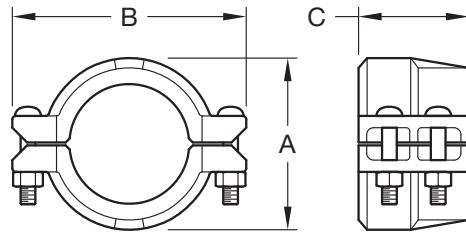

Nominal Pipe Size		Nominal Dimensions			Coupling Bolt Size Inches	Approx. Weight Lbs. (kg)
ANSI Inches DN	O.D. Inches (mm)	A Inches (mm)	B Inches (mm)	C Inches (mm)		
2 DN50	2.375 (60,3)	3.39 (86,0)	5.99 (152,0)	3.11 (79,0)	1/2 x 2-3/8	4.4 (2,0)
3 DN80	3.500 (88,9)	4.49 (114,0)	7.13 (181,0)	3.11 (79,0)	1/2 x 3	5.9 (2,7)
4 DN100	4.500 (114,3)	5.75 (146,0)	8.50 (216,0)	3.74 (95,0)	1/2 x 3	8.4 (3,8)
6 DN150	6.625 (168,3)	8.00 (203,0)	11.26 (286,0)	3.74 (95,0)	5/8 x 3-1/2	12.5 (5,7)
8 DN200	8.625 (219,1)	10.51 (267,0)	13.63 (346,0)	4.25 (108,0)	5/8 x 3-1/2	21.3 (9,7)
10 DN250	10.750 (273,0)	12.64 (321,0)	17.00 (432,0)	5.00 (127,0)	3/4 x 4-3/4	35.2 (16,0)
12 DN300	12.750 (323,9)	14.76 (375,0)	19.49 (495,0)	5.00 (127,0)	3/4 x 4-3/4	43.1 (19,6)

**FIGURE 1**  
**NOMINAL DIMENSIONS FIGURE 9097 HDPE TRANSITION COUPLING**

Nominal Pipe Size				Pipe Wall Thickness and Standard Dimension Ratio						
ANSI Inches DN	O.D. Inches (mm)	Tolerance +/- Inches (mm)	Maximum Pipe Ovality +/- Inches (mm)	SDR 7.3 Inches (mm)	SDR 9 Inches (mm)	SDR 11 Inches (mm)	SDR 15.5 Inches (mm)	SDR 17 Inches (mm)	SDR 21 Inches (mm)	SDR 32.5 Inches (mm)
2 DN50	2.375 (60,3)	0.006 (0.15)	0.035 (0.89)	0.325 (8.3)	0.264 (6.7)	0.216 (5.5)	0.153 (3.9)	0.140 (3.6)	0.113 (2.9)	-
3 DN80	3.500 (88,9)	0.016 (0.41)	0.040 (1.02)	0.479 (12.2)	0.389 (9.9)	0.318 (8.1)	0.226 (5.7)	0.206 (5.2)	0.167 (4.2)	0.108 (2.7)
4 DN100	4.500 (114,3)	0.020 (0.51)	0.040 (1.02)	0.616 (15.6)	0.500 (12.7)	0.409 (10.4)	0.290 (7.4)	0.265 (6.7)	0.214 (5.4)	0.138 (3.5)
6 DN150	6.625 (168,3)	0.030 (0.76)	0.050 (1.27)	0.908 (23.1)	0.736 (18.7)	0.602 (15.3)	0.427 (10.8)	0.327 (8.3)	0.265 (6.7)	0.204 (5.2)
8 DN200	8.625 (219,1)	0.039 (0.99)	0.075 (1.91)	1.182 (30.0)	0.958 (24.3)	0.784 (19.9)	0.556 (14.1)	0.507 (12.9)	0.340 (8.6)	0.265 (6.7)
10 DN250	10.750 (273,0)	0.048 (1.22)	0.075 (1.91)	1.473 (37.4)	1.194 (30.3)	0.977 (24.8)	0.694 (17.6)	0.632 (16.1)	0.512 (13.0)	0.331 (8.4)
12 DN300	12.750 (323,9)	0.057 (1.45)	0.075 (1.91)	1.747 (44.4)	1.417 (36.0)	1.159 (29.4)	0.823 (20.9)	0.750 (19.1)	0.607 (15.4)	0.392 (10.0)

Per Specification for Polyethylene (P.E.) Plastic Pipe ASTM F714, D2447, D3035

**FIGURE 2**  
**HDPE PIPE DIMENSIONAL SPECIFICATIONS**

GRINNELL Mechanical Products valve, accessories and other products are available throughout the U.S., Canada and internationally through a network of distribution centers.



800-558-5236  
www.grinnell.com



**Grinnell**  
MECHANICAL PRODUCTS

by Tyco Fire Suppression & Building Products